

AUTO ZIP LINE - SEATBELT INSTALLATION INSTRUCTIONS

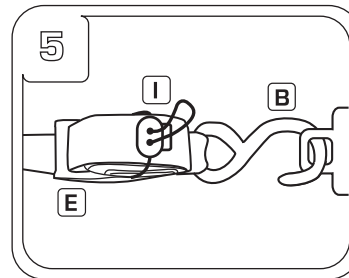

More setup options on reverse side

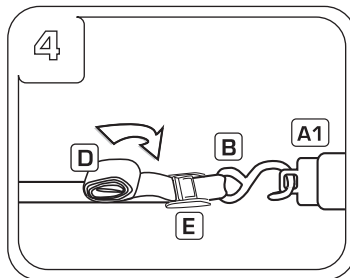
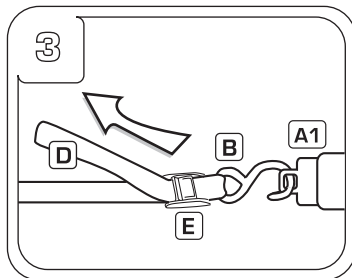
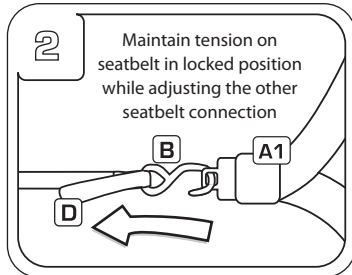
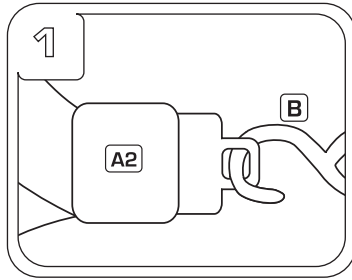
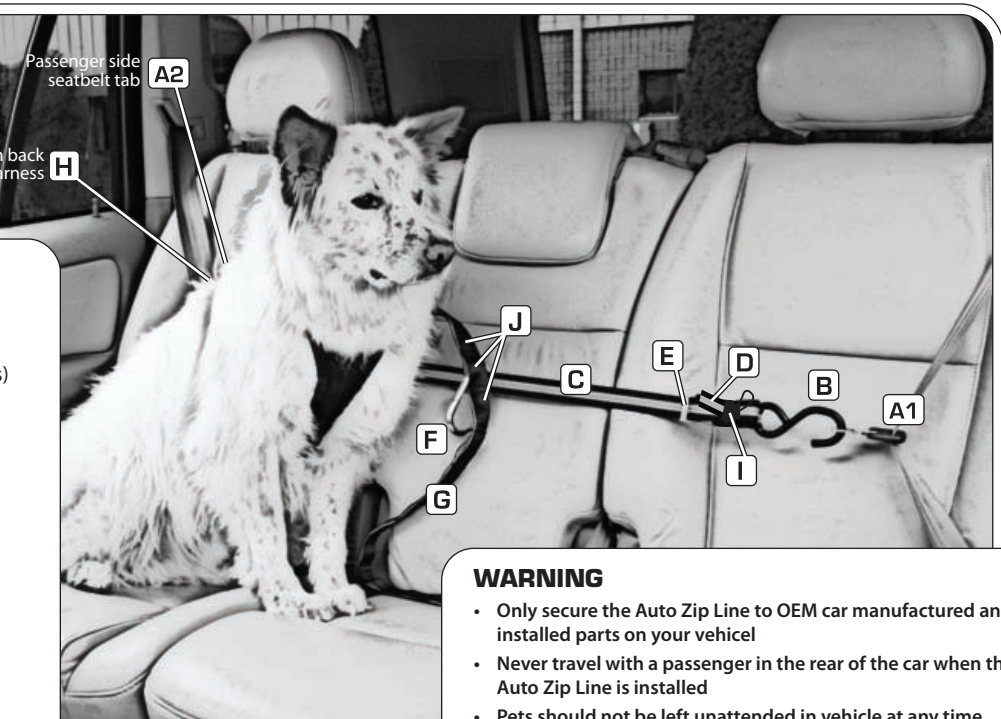

KEY

- A1** Seatbelt tab (rear drivers)
- A2** Seatbelt tab (rear passengers)
- B** S-hook
- C** Nylon zip-line
- D** Extra zip-line webbing
- E** Cam buckle
- F** Carabineer
- G** Wander leash/tether
- H** Harness D-ring
- I** Bungee & toggle
- J** Leash nook

WARNING

- Only secure the Auto Zip Line to OEM car manufactured and installed parts on your vehicle
- Never travel with a passenger in the rear of the car when the Auto Zip Line is installed
- Pets should not be left unattended in vehicle at any time
- Ensure proper installation of the Zip Line before each trip

AUTO ZIP LINE - ALTERNATE INSTALLATION OPTIONS



Passenger handle installation (fig. 1)

1. Place the two s-hooks onto the rear passenger handles.
2. Tighten the zip line by pulling the extra webbing through the cam buckle.
3. Roll up extra webbing toward cam buckle and secure using bungee & toggle setup.
4. Place carabineer onto zip line.
5. Attach leash clip to harness D-ring.
6. Locate appropriate leash nook that permits Fido to sit up and lay down and loop onto the carabineer.



Seatbelt installation (fig. 2)

1. Buckle seatbelt and attach the carabineer.
2. Locate appropriate leash nook that permits Fido to sit up and lay down and loop onto the carabineer.
3. Attach leash to D-ring on harness.



Cargo hook installation (fig. 3)

1. Attach carabineer to cargo hook.
2. Locate appropriate leash nook that permits Fido to sit up and lay down and loop onto the carabineer.
3. Attach leash to D-ring on harness.

Safety/walking harness instructions (fig. 4)

1. Place upper strap (with steel D-ring) around pet's neck.
2. Place 2 lower straps around pet's chest and behind front legs.
3. Fasten side release buckles on both sides.
4. Adjust upper and lower straps to fit comfortably and securely.



safety/walking harness parts

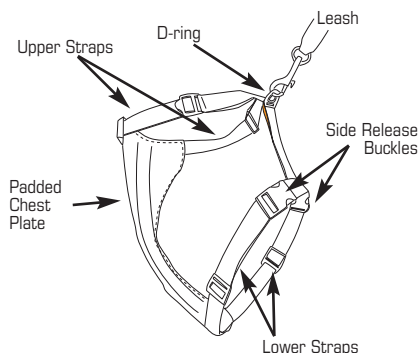

WASHING INSTRUCTIONS:

- Brush off loose dirt with a dry brush
- As needed, wipe off with a damp sponge and mild soap
- Rinse only, if possible. Use cold water and a sponge or rinse in a tub without soap
- Machine wash in front-loading unit (DO NOT use machine with agitator), with cold water and mild soap etc. Not detergents
- Rinse thoroughly to eliminate soap residue
- Lay flat to dry



See the complete Dog Travel line at kurgo.com



Some small harness versions:

In some newer versions of the Small Auto Zip Line harness the tether clip has been designed to hook directly to the back of the harness. The small silver d-ring on the back can be used for walking.

Quelques petites versions de harnais :

Dans quelques plus nouvelles versions de la petite ligne automatique harnais de fermeture éclair le clip de longe a été conçu pour s'accrocher directement au.



See the complete dog travel line at kurgo.com