

back seat BARRIER™

INSTALLATION & CARE

1

KEY:

- (A) inner elastic strap
- (B) outer D-ring
- (C) bottom strap clip
- (D) top headrest strap
- (E) headrest buckle
- (F) bottom strap
- (G) upper D-ring
- (H) backseat divider
- (I) divider snap
- (J) bottom elastic cord
- (K) barrier extension
- (L) support column area
- (M) barrier extension zipper
- (N) barrier extension strap
- (O) small D-ring
- (P) latterlock buckle

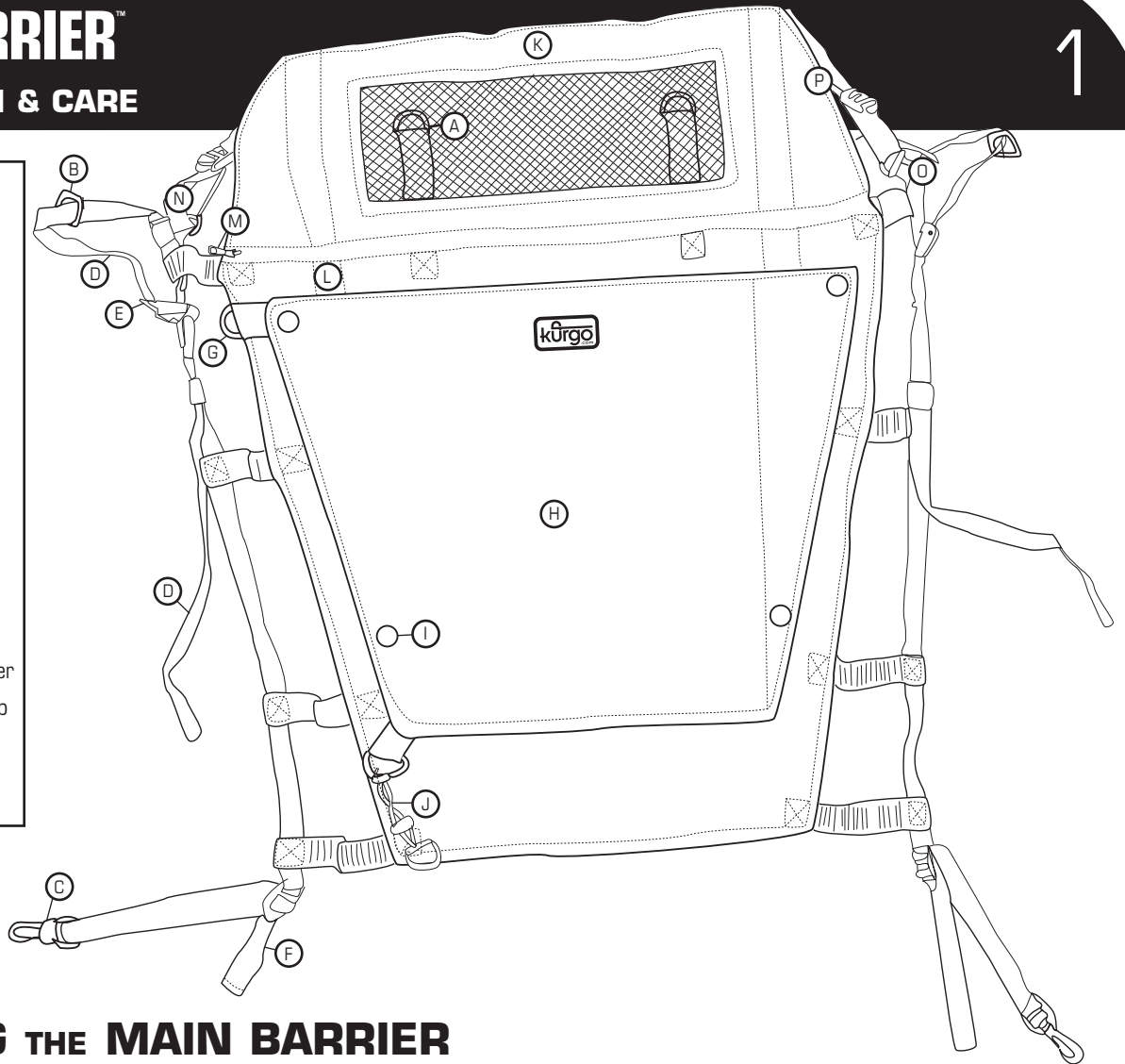

ATTACHING THE MAIN BARRIER

For Vehicles With Detachable Headrests:

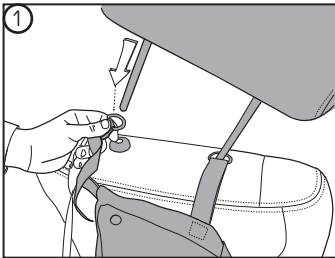

1 Orient the barrier so the Kurgo logo is facing the back of the car. Remove the driver's seat headrest. Slide the headrest columns through the large D-ring (A). Slide outer D-ring (B) through outer headrest column. Repeat on an other side.

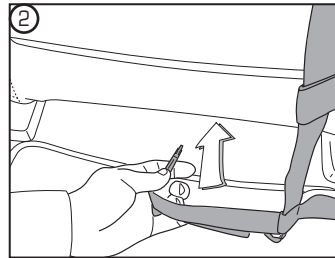

2 Clip the bottom strap (C) to springs or base plate under the front seat. Repeat attaching other strap (C) to the bottom of the seat on the other side.

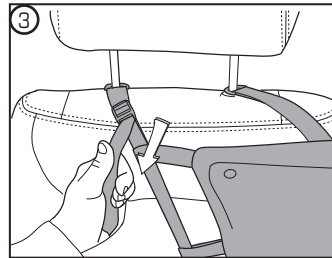

3 Pull the top headrest straps (D) tight on both sides.

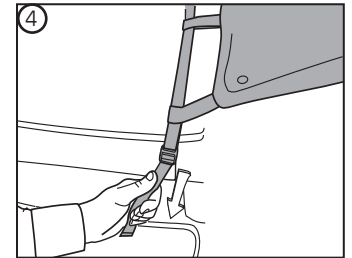

4 Pull the bottom straps tight (F) on both sides.

For Vehicles Without Detachable Headrests:

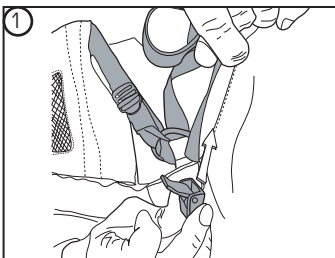

1 Pull the top headrest strap of the Main Barrier (D) out of its buckle (E).

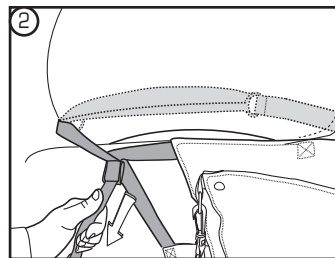

2 Wrap the headrest strap (D) around the headrest. Insert the strap through the large D-ring attached to the inner elastic strap (A). Bring the strap back around the headrest and run the strap through its buckle (E). Repeat on the other headrest.

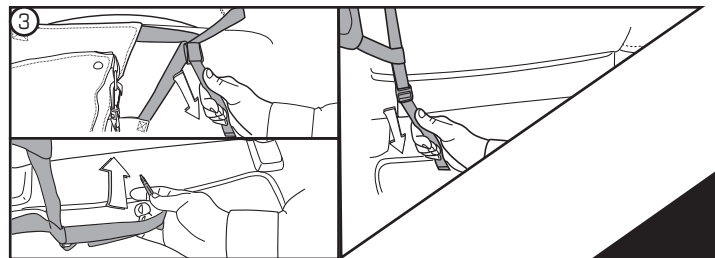

3 Pull the top headrest straps (D) tight on both sides. Clip the bottom straps (C) under the 2 front seats. Pull the bottom straps (F) tight.

FLIP FOR
DIVIDER &
EXTENSION
DIRECTIONS

ATTACHING THE BARRIER EXTENSION

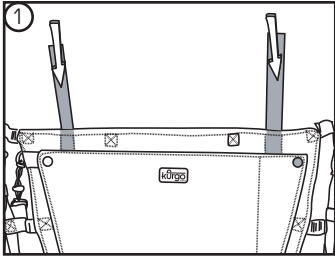

Slide the metal support columns into the Main Barrier (L) behind the zipper.

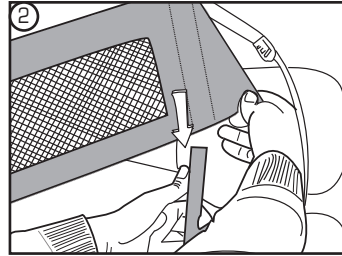

Slide the Barrier Extension (K) on the support columns. Zip the Barrier Extension.

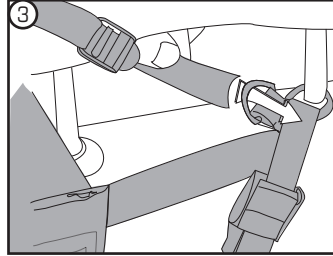

On one side, run the Barrier Extension strap (N) through the small D-ring (O) of the outer strap attached to the Main Barrier.

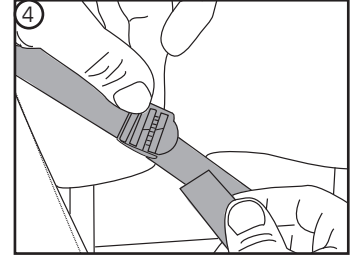

Run the Barrier Extension strap (N) back through its latherlock buckle (P) and pull the strap tight. Repeat steps 3+4 on other side.

USING THE BACKSEAT DIVIDER

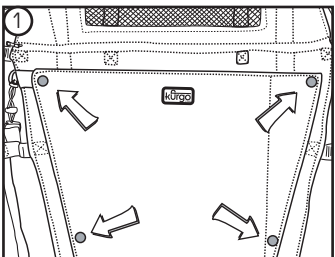

After the main barrier is set up, undo the 4 snaps (I).

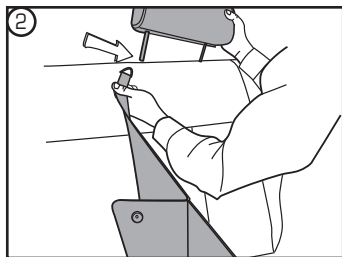

FOR VEHICLES WITH DETACHABLE HEADRESTS:
Remove the backseat headrest and slide the headrest column through the upper D-ring (G) of the Backseat Divider (H).

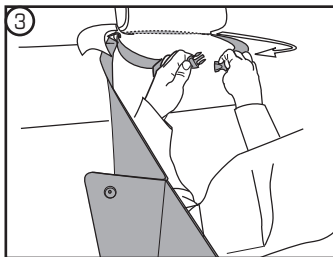

FOR VEHICLES WITHOUT DETACHABLE HEADRESTS:
Use the extra strap to attach the Backseat Divider (H) to the back headrest or to the back seat baby hook.

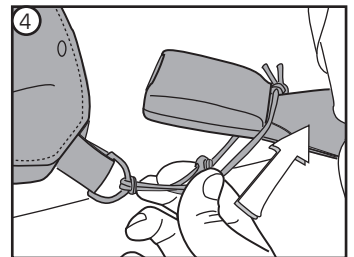

Wrap the bottom elastic cord (J) around the seat belt stem and pull it tight. To shorten, tie a knot in the extra cord.

WASHING INSTRUCTIONS:



- Brush off loose dirt with a dry brush
- As needed, wipe off with a damp sponge and mild soap
- Rinse only, if possible. Use cold water and a sponge or rinse in a tub without soap
- Machine wash in front-loading unit (DO NOT use machine with agitator; agitator could cause damage not covered under warranty) with cold water and mild soap (Ivory Flakes, Woolite, Sport Wash, Etc.) Not detergents
- Rinse thoroughly to eliminate soap residue.
- Lay flat to dry.

For additional information:

877.847.3868

:: www.kurgo.com

:: info@kurgo.com

kurgo